

Large Capacity Range Available from 1,000 square feet cloth area upwards, all with fully automatic shaker cleaning facility.

Specification				
Model	Standard Fan Rating	Filter Area	Motor Power	
		m ²	hp	kW
FEX 1000	6000 cfm @ 9"wg 10200m ³ /hr @ 225mm	92.9	15	11.00
FEX 1125	6750 cfm @ 9"wg 11475m ³ /hr @ 225mm	104.5	15	11.00
FEX 1200	7200 cfm @ 9"wg 12245m ³ /hr @ 225mm	111.5	20	15.00
FEX 1240	9000 cfm @ 9"wg 15305m ³ /hr @ 225mm	115.2	20	15.00
FEX 1500	9000 cfm @ 9"wg 15305m ³ /hr @ 225mm	139.3	20	15.00
FEX 1650	9900 cfm @ 9"wg 16835m ³ /hr @ 225mm	153.3	25	18.50
FEX 2000	12000 cfm @ 9"wg 20410m ³ /hr @ 225mm	185.8	30	22.00
FEX 2250	13500 cfm @ 9"wg 22960m ³ /hr @ 225mm	209.0	30	22.00
FEX 2400	14400 cfm @ 9"wg 24490m ³ /hr @ 225mm	223.0	40	30.00
FEX 2475	14800 cfm @ 9"wg 25160m ³ /hr @ 225mm	230.0	40	30.00
FEX 3000	18000 cfm @ 9"wg 30610m ³ /hr @ 225mm	278.7	40	30.00
FEX 3300	19800 cfm @ 9"wg 33670m ³ /hr @ 225mm	306.6	50	37.00



Valley Hopper – FEX3000

Model	Specification									2 x Inlets		No. of Shaker Motors 0.25 hp (0.18 kW)	No. of	
	A mm	B mm	D mm	E mm	F mm	G mm	H mm	J mm	L mm	M mm	Hoppers		Bins	
FEX 1000	1610	2000	2175	-	5500	3285	864	3505	549	232	2	1	4	
FEX 1125	3078	1125	2060	-	5500	3210	915	3500	613	308	2	1	3	
FEX 1200	1610	2000	2175	-	5500	3285	864	3500	549	232	2	1	4	
FEX 1240	3078	1125	2060	-	5500	3210	915	3500	613	308	2	1	3	
FEX 1500	2055	2250	2445	2250	5500	3595	915	3500	613	308	2	1	4	
FEX 1650	2055	2250	2445	2250	5500	3595	915	3500	613	308	2	1	4	
FEX 2000	1610	-	-	4985	5500	-	-	3500	1222	613	4	2	-	
FEX 2250	3078	2250	2445	-	5500	3595	915	3500	1222	613	4	1	6	
FEX 2400	1610	-	-	4985	5500	-	-	3500	1222	613	4	2	-	
FEX 2475	3078	2250	2445	-	5500	3595	915	3500	613	308	4	1	6	
FEX 3000	2055	-	-	5640	5500	-	-	3500	1222	613	4	3	-	
FEX 3300	2055	-	-	5640	5500	-	-	3500	1222	613	4	3	-	

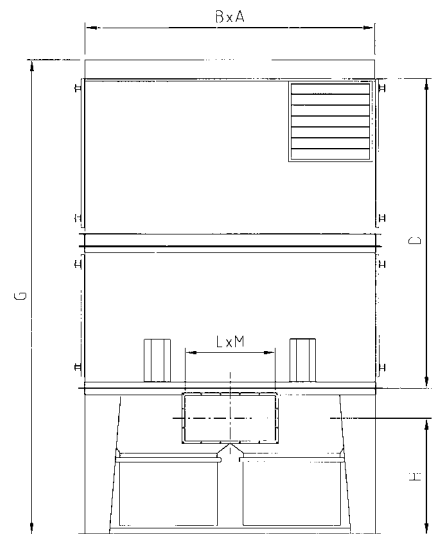

Standard Hopper – FEX1000 to FEX1650
Hopper – Containing Fan, Silencer, Filter Media, Hopper and Bin Collection

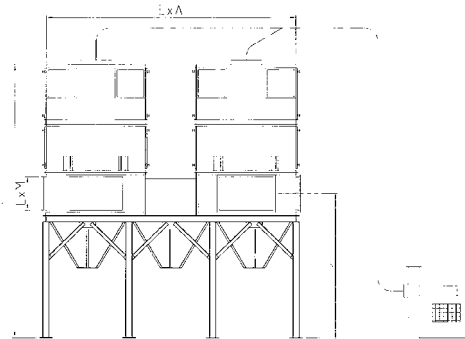

Valley Hopper – Large capacity filter units with Valley Hopper collection facility, mounted on supporting steelwork



Valley Hopper – With floor mounting fan FEX1000 to FEX3000

Due to the continued improvement of our products, specifications may vary from those provided in this leaflet. We reserve the right to alter specifications and dimensions without prior notice. Any non standard sizes manufactured to specific requirements. All dimensions quoted are approximate.



FEX 3754 and FEX 250H units fitted with pressure stabilisers

All are self-contained, high efficiency, envelope type units of compact design. They incorporate fan, motor and filter assemblies with either hand or mechanically operated shaking mechanisms and are designed to accept combinations of fan volume/cloth area to meet the varying applications in industry. Full width hinged access doors, with quick release fasteners, provide easy inspection or removal of fan, motor or filter.

The automatic electrical shaking mechanism control unit consists of contactors and time delay relays, so that when the stop button is operated, the fan motor is allowed to run down before the shaker motor is automatically energised. This then runs for a pre-determined period, after which the whole system is shut down and reset.

Acoustic Diffusers All FEX dust filter units are fitted with an acoustic diffuser, which is built into the fan chamber as standard.



FEX 1650/H

Earth Braids

Where static prone dusts are being handled, earth braids are available for the full range of units. This problem can be overcome by using alternative fabrics incorporating carbon fibres in the structure of the material.

Specification						
Model	Standard Fan Rating		Filter Area m ²	Motor Power		
				hp	kW	
FEX 50	400 cfm @ 6.3" swg	680 m ³ /Hr @ 160mm	4.64	¼	0.55	
FEX 75	600 cfm @ 7.0" swg	1020 m ³ /Hr @ 178mm	6.97	2	1.50	
FEX 100	800 cfm @ 7.0" swg	1360 m ³ /Hr @ 178mm	9.23	3	2.20	
FEX 125	1000 cfm @ 7.0" swg	1700 m ³ /Hr @ 178mm	11.61	3	2.20	
FEX 150	1200 cfm @ 7.0" swg	2040 m ³ /Hr @ 178mm	13.94	4	3.00	
FEX 175	1400 cfm @ 7.0" swg	2380 m ³ /Hr @ 178mm	16.26	4	3.00	
FEX 205	1600 cfm @ 7.0" swg	2720 m ³ /Hr @ 178mm	19.00	5.5	4.00	
FEX 250	2000 cfm @ 7.0" swg	3400 m ³ /Hr @ 178mm	23.23	7.5	5.50	
FEX 294	2350 cfm @ 7.0" swg	4000 m ³ /Hr @ 178mm	27.30	10	7.50	
FEX 375	3000 cfm @ 7.0" swg	5100 m ³ /Hr @ 178mm	34.84	10	7.50	
FEX 440	3500 cfm @ 7.0" swg	5950 m ³ /Hr @ 178mm	40.90	10	7.50	
FEX 500	4000 cfm @ 7.5" swg	6800 m ³ /Hr @ 190mm	46.46	12	9.00	
FEX 600	4800 cfm @ 7.5" swg	8165 m ³ /Hr @ 190mm	55.70	12	9.00	
FEX 750	6000 cfm @ 8.8" swg	10200 m ³ /Hr @ 225mm	69.69	15	11.00	
FEX 825	6600 cfm @ 8.8" swg	11225 m ³ /Hr @ 225mm	76.60	15	11.00	

The above design duties are based on an 8:1 cloth to air ratio. Polyester needfelt filter media is included as standard throughout our range. Other filter medias are available.

Specification							
Model	Approximate Weight Kg		Bin Capacity Type H Units				Noise Level @ 2 mtrs dB(A)
			Capacity		Capacity with Stabilisers		
	Type H	Type D	Cu. ft.	Ltr.	Cu. ft.	Ltr.	
FEX 30	65	59	1.7	48	1.5	42	73
FEX 50	82	74	2.7	76	2.3	65	73
FEX 75	245	225	2.3	66	1.9	53	75
FEX 100	265	245	2.3	66	1.9	53	74
FEX 125	270	250	2.3	66	1.9	53	75
FEX 150	275	255	2.3	66	1.9	53	76
FEX 175	370	335	4.6	130	4.0	113	76
FEX 205	380	345	4.6	130	4.0	113	76
FEX 250	440	405	4.6	130	4.0	113	76
FEX 294	460	425	4.6	130	4.0	113	76
FEX 375	520	485	5.7	161	5.0	142	78
FEX 440	540	505	5.7	161	5.0	142	78
FEX 500	725	-	2 x 3.6	2 x 102	2 x 3.2	2 x 90	82
FEX 600	750	-	2 x 3.6	2 x 102	2 x 3.2	2 x 90	82
FEX 750	875	-	2 x 5.8	2 x 164	2 x 5.2	2 x 148	82
FEX 825	900	-	2 x 5.8	2 x 164	2 x 5.2	2 x 148	82

Due to the continued improvement of our products, specifications may vary from those provided in this leaflet. We reserve the right to alter specifications and dimensions without prior notice. Any non standard sizes manufactured to specific requirements. All dimensions quoted are approximate.



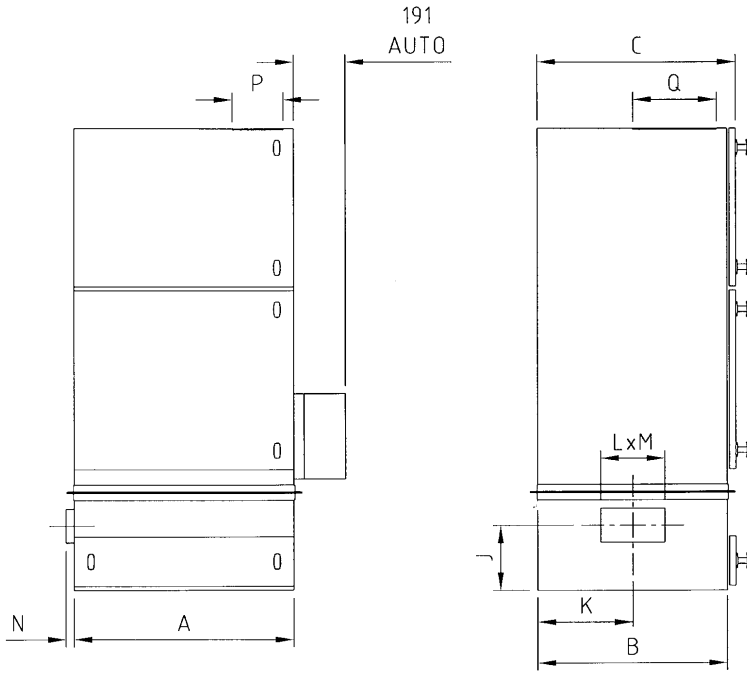

Type D Units

This designates drawer units and again describes the type of dust collector provided at the base. Assemblies are as above for hopper units, and they again range from 30 to 375 sq.ft. (2.7 - 34.84 m²).

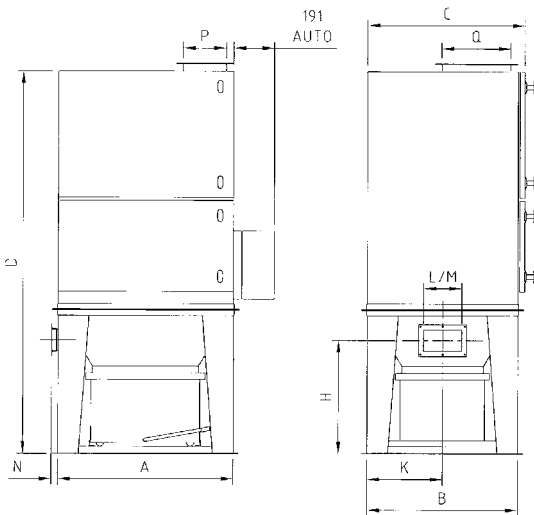

Type H Units

This designates hopper units and describes the type of dust collection provided at the base. They incorporate standard fan, filter and dust collecting assemblies with bolt on inlet to fit either side. They range from 30 to 825 sq.ft. (2.7 - 76.6 m²).

Specification													
Model	A mm	B mm	C mm	D mm	E mm	H mm	J mm	K mm	L mm	M mm	N mm	P mm	Q mm
FX 75	850	729	762	1885	1539	559	254	364	181	105	32	197	322
FX 100	850	729	762	2139	1793	559	254	364	244	130	32	197	322
FX 125	850	729	762	2139	1793	559	254	364	244	130	32	197	322
FX 150	850	729	762	2139	1793	559	254	364	244	130	32	197	322
FX 175	1161	881	914	2256	1909	711	406	440	283	156	32	472	272
FX 205	1161	881	914	2256	1909	711	406	440	283	156	32	472	272
FX 250	1161	881	914	2459	2112	711	406	440	345	181	32	472	272
FX 294	1161	881	914	2459	2112	711	406	440	345	181	32	472	272
FX 375	1161	998	1029	2670	2400	711	508	497	454	206	38	472	322
FX 440	1161	998	1029	2670	2400	711	508	497	454	206	38	472	322
FX 500	1610	998	1029	3160	-	864	-	497	549	232	38	522	472
FX 600	1610	998	1029	3160	-	864	-	497	549	232	38	522	472
FX 750	2055	1125	1156	3210	-	915	-	562	613	308	50	747	472
FX 825	2055	1125	1156	3210	-	915	-	562	613	308	50	747	472

Explosion Doors

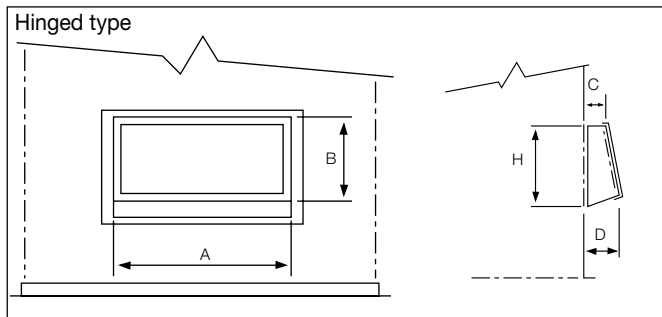

Explosion relief doors are fitted as standard to the rear of the unit

Specification					
Model	A mm	B mm	C mm	D mm	H mm
FEX 30	300	150	40	75	200
FEX 50	400	150	40	75	200
FEX 75	400	190	50	90	220
FEX 100 & 150	460	230	50	90	265
FEX 175 & 205	600	280	60	115	320
FEX 250 & 294	760	285	60	115	325
FEX 375 & 440	760	460	75	150	515
FEX 500 & 600	915	460	75	150	515
FEX 750 & 825	2 off FEX 375 fitted equi-spaced on rear				

Due to the continued improvement of our products, specifications may vary from those provided in this leaflet. We reserve the right to alter specifications and dimensions without prior notice. Any non standard sizes manufactured to specific requirements. All dimensions quoted are approximate.



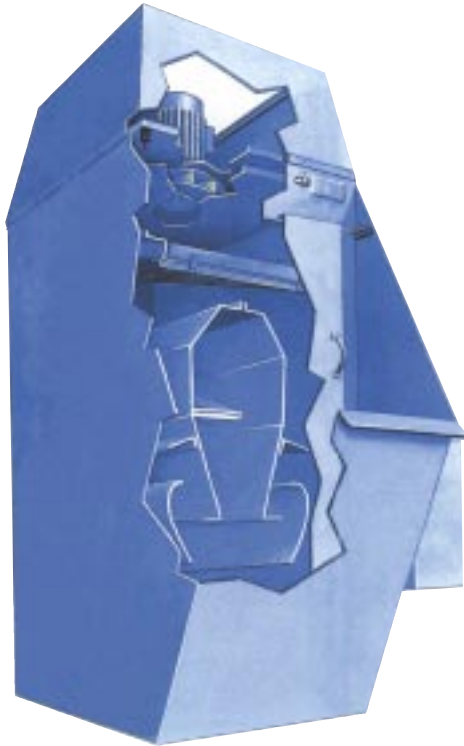

FAN AVAILABILITY

Unit size	0.75 kW	1.1 kW	2.2 kW	3.0 kW	4.0 kW	5.5 kW	7.5 kW	11.0 kW	15.0 kW
FF30	●								
FF60		●							
FF80			●	●					
FF120					●	●			
FF185						●	●	●	
FF220									●



Model FF220 15 kW with magnesium conversion kit

Reliable in operation and easy to maintain. Ideal for aluminium and other flammable dusts.
Flame-Free is a self-induced spray wet scrubber designed to cope with difficult fibrous dusts. It is a unique design that has evolved over many years. The Flame-Free has been developed to control dusts and keep the environment clean and safe from the pollution, produced by a wide range of modern industrial processes. The design and construction of the Flame-Free unit reduces the risk of blockages and allows quick and easy maintenance. The design also conforms to many countries' mandatory requirements for handling explosion generating dusts.

Simple eliminator change
Spray eliminators are removable for easy cleaning and reduced downtime during preventative maintenance.

Manual, hopper or mechanical discharge
316L Stainless steel option

Water level indication
A simple sight tube is fitted to allow a quick and easy check that the system operating level is correct.

Automatic level control
A simple trouble-free ball valve water control can be fitted to allow for continuous water replacement for effective air cleaning. This is standard on some of the larger models.

Acoustic treatment
Keeping the atmosphere free of pollution from industrial dusts is essential. Limiting the noise emitted by industrial equipment is another facet of keeping the environment as pure as we possibly can. The Fercell Flame-Free offers an acoustic device to keep noise levels down to acceptable limits.

Dust collection and disposal
For the disposal of sludge and collected dust particles Fercell offer two alternatives for the smaller models and a third for larger models: a simple rake and bin, a hopper discharge, complete with sludge valve and on larger models a mechanical rake-out mechanism.

Fan
Fercell dust collectors have backward curved free vortex fans. They are directly driven at 2880 rpm (50 Hz). Experience and development has produced a series of fans with steep performance curves, which means that a large variation in system resistances causes only a small change in air volume being handled, in contrast to fans fitted in competitive units. The motor, fan back-plate and impeller assembly are mounted on anti-vibration mounts, which together with electronic balancing result in very smooth running fans.

Self-induced scrubbing
Unique to Fercell Flame-Free is the generous space between the inducer baffles, reducing the risk of blockage. The simple design evolved over many years of testing and development has produced a reliable and effective spray inducer, which generates an impressive scrubbing action. Another advantage of the generous space between the baffles is the easy access for regular maintenance checks and inspections.

Hazardous dusts
The Flame-Free is ideal for materials that are likely to generate sparks or become unstable when being worked. Flame-Free conforms to the requirements of the aluminium regulations in the UK and USA. With the addition of special controls the magnesium and titanium requirements are also catered for.

- Optional extras**
- Anti-spark precautions
 - Acoustic ducts
 - Special water level controls
 - Weather protection
 - Frost protection
 - Total system application and design
 - Stainless steel 316L construction
 - One size available in Glass Reinforced Plastic
 - After-sales service and LEV/ COSHH testing
 - Water additives

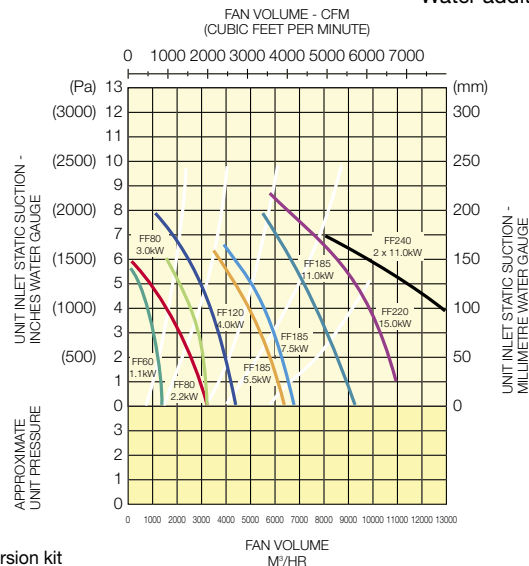

Due to the continued improvement of our products, specifications may vary from those provided in this leaflet. We reserve the right to alter specifications and dimensions without prior notice. Any non standard sizes manufactured to specific requirements. All dimensions quoted are approximate.