

Large Capacity Range Available from 1,000 square feet cloth area upwards, all with fully automatic shaker cleaning facility.

Specification				
Model	Standard Fan Rating	Filter Area	Motor Power	
		m ²	hp	kW
FEX 1000	6000 cfm @ 9"wg 10200m ³ /hr @ 225mm	92.9	15	11.00
FEX 1125	6750 cfm @ 9"wg 11475m ³ /hr @ 225mm	104.5	15	11.00
FEX 1200	7200 cfm @ 9"wg 12245m ³ /hr @ 225mm	111.5	20	15.00
FEX 1240	9000 cfm @ 9"wg 15305m ³ /hr @ 225mm	115.2	20	15.00
FEX 1500	9000 cfm @ 9"wg 15305m ³ /hr @ 225mm	139.3	20	15.00
FEX 1650	9900 cfm @ 9"wg 16835m ³ /hr @ 225mm	153.3	25	18.50
FEX 2000	12000 cfm @ 9"wg 20410m ³ /hr @ 225mm	185.8	30	22.00
FEX 2250	13500 cfm @ 9"wg 22960m ³ /hr @ 225mm	209.0	30	22.00
FEX 2400	14400 cfm @ 9"wg 24490m ³ /hr @ 225mm	223.0	40	30.00
FEX 2475	14800 cfm @ 9"wg 25160m ³ /hr @ 225mm	230.0	40	30.00
FEX 3000	18000 cfm @ 9"wg 30610m ³ /hr @ 225mm	278.7	40	30.00
FEX 3300	19800 cfm @ 9"wg 33670m ³ /hr @ 225mm	306.6	50	37.00



Valley Hopper – FEX3000

Model	Specification								2 x Inlets		No. of Shaker Motors 0.25 hp (0.18 kW)	No. of	
	A mm	B mm	D mm	E mm	F mm	G mm	H mm	J mm	L mm	M mm		Hoppers	Bins
FEX 1000	1610	2000	2175	-	5500	3285	864	3505	549	232	2	1	4
FEX 1125	3078	1125	2060	-	5500	3210	915	3500	613	308	2	1	3
FEX 1200	1610	2000	2175	-	5500	3285	864	3500	549	232	2	1	4
FEX 1240	3078	1125	2060	-	5500	3210	915	3500	613	308	2	1	3
FEX 1500	2055	2250	2445	2250	5500	3595	915	3500	613	308	2	1	4
FEX 1650	2055	2250	2445	2250	5500	3595	915	3500	613	308	2	1	4
FEX 2000	1610	-	-	4985	5500	-	-	3500	1222	613	4	2	-
FEX 2250	3078	2250	2445	-	5500	3595	915	3500	1222	613	4	1	6
FEX 2400	1610	-	-	4985	5500	-	-	3500	1222	613	4	2	-
FEX 2475	3078	2250	2445	-	5500	3595	915	3500	613	308	4	1	6
FEX 3000	2055	-	-	5640	5500	-	-	3500	1222	613	4	3	-
FEX 3300	2055	-	-	5640	5500	-	-	3500	1222	613	4	3	-

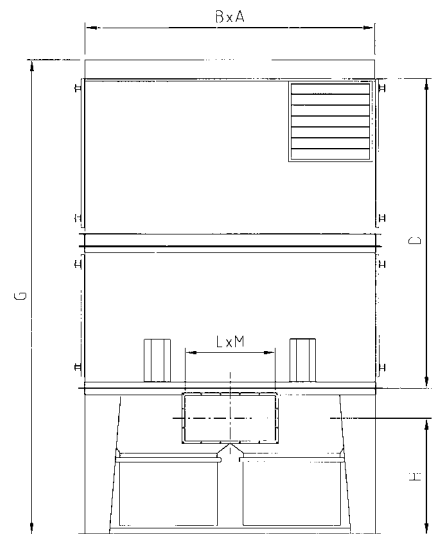

Standard Hopper – FEX1000 to FEX1650
Hopper – Containing Fan, Silencer, Filter Media, Hopper and Bin Collection

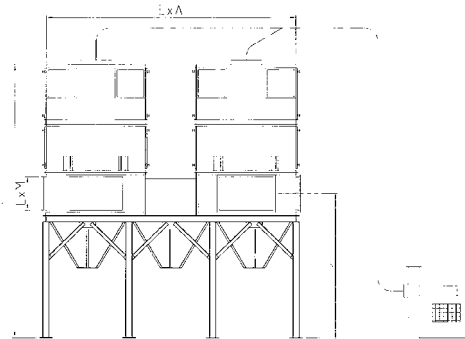

Valley Hopper – Large capacity filter units with Valley Hopper collection facility, mounted on supporting steelwork



Valley Hopper – With floor mounting fan FEX1000 to FEX3000

Due to the continued improvement of our products, specifications may vary from those provided in this leaflet. We reserve the right to alter specifications and dimensions without prior notice. Any non standard sizes manufactured to specific requirements. All dimensions quoted are approximate.



FEX 3754 and FEX 250H units fitted with pressure stabilisers

All are self-contained, high efficiency, envelope type units of compact design. They incorporate fan, motor and filter assemblies with either hand or mechanically operated shaking mechanisms and are designed to accept combinations of fan volume/cloth area to meet the varying applications in industry. Full width hinged access doors, with quick release fasteners, provide easy inspection or removal of fan, motor or filter.

The automatic electrical shaking mechanism control unit consists of contactors and time delay relays, so that when the stop button is operated, the fan motor is allowed to run down before the shaker motor is automatically energised. This then runs for a pre-determined period, after which the whole system is shut down and reset.

Acoustic Diffusers All FEX dust filter units are fitted with an acoustic diffuser, which is built into the fan chamber as standard.



FEX 1650/H

Earth Braids

Where static prone dusts are being handled, earth braids are available for the full range of units. This problem can be overcome by using alternative fabrics incorporating carbon fibres in the structure of the material.

Specification						
Model	Standard Fan Rating		Filter Area m ²	Motor Power		
				hp	kW	
FEX 50	400 cfm @ 6.3" swg	680 m ³ /Hr @ 160mm	4.64	¼	0.55	
FEX 75	600 cfm @ 7.0" swg	1020 m ³ /Hr @ 178mm	6.97	2	1.50	
FEX 100	800 cfm @ 7.0" swg	1360 m ³ /Hr @ 178mm	9.23	3	2.20	
FEX 125	1000 cfm @ 7.0" swg	1700 m ³ /Hr @ 178mm	11.61	3	2.20	
FEX 150	1200 cfm @ 7.0" swg	2040 m ³ /Hr @ 178mm	13.94	4	3.00	
FEX 175	1400 cfm @ 7.0" swg	2380 m ³ /Hr @ 178mm	16.26	4	3.00	
FEX 205	1600 cfm @ 7.0" swg	2720 m ³ /Hr @ 178mm	19.00	5.5	4.00	
FEX 250	2000 cfm @ 7.0" swg	3400 m ³ /Hr @ 178mm	23.23	7.5	5.50	
FEX 294	2350 cfm @ 7.0" swg	4000 m ³ /Hr @ 178mm	27.30	10	7.50	
FEX 375	3000 cfm @ 7.0" swg	5100 m ³ /Hr @ 178mm	34.84	10	7.50	
FEX 440	3500 cfm @ 7.0" swg	5950 m ³ /Hr @ 178mm	40.90	10	7.50	
FEX 500	4000 cfm @ 7.5" swg	6800 m ³ /Hr @ 190mm	46.46	12	9.00	
FEX 600	4800 cfm @ 7.5" swg	8165 m ³ /Hr @ 190mm	55.70	12	9.00	
FEX 750	6000 cfm @ 8.8" swg	10200 m ³ /Hr @ 225mm	69.69	15	11.00	
FEX 825	6600 cfm @ 8.8" swg	11225 m ³ /Hr @ 225mm	76.60	15	11.00	

The above design duties are based on an 8:1 cloth to air ratio. Polyester needfelt filter media is included as standard throughout our range. Other filter medias are available.

Specification							
Model	Approximate Weight Kg		Bin Capacity Type H Units				Noise Level @ 2 mtrs dB(A)
			Capacity		Capacity with Stabilisers		
	Type H	Type D	Cu. ft.	Ltr.	Cu. ft.	Ltr.	
FEX 30	65	59	1.7	48	1.5	42	73
FEX 50	82	74	2.7	76	2.3	65	73
FEX 75	245	225	2.3	66	1.9	53	75
FEX 100	265	245	2.3	66	1.9	53	74
FEX 125	270	250	2.3	66	1.9	53	75
FEX 150	275	255	2.3	66	1.9	53	76
FEX 175	370	335	4.6	130	4.0	113	76
FEX 205	380	345	4.6	130	4.0	113	76
FEX 250	440	405	4.6	130	4.0	113	76
FEX 294	460	425	4.6	130	4.0	113	76
FEX 375	520	485	5.7	161	5.0	142	78
FEX 440	540	505	5.7	161	5.0	142	78
FEX 500	725	-	2 x 3.6	2 x 102	2 x 3.2	2 x 90	82
FEX 600	750	-	2 x 3.6	2 x 102	2 x 3.2	2 x 90	82
FEX 750	875	-	2 x 5.8	2 x 164	2 x 5.2	2 x 148	82
FEX 825	900	-	2 x 5.8	2 x 164	2 x 5.2	2 x 148	82

Due to the continued improvement of our products, specifications may vary from those provided in this leaflet. We reserve the right to alter specifications and dimensions without prior notice. Any non standard sizes manufactured to specific requirements. All dimensions quoted are approximate.



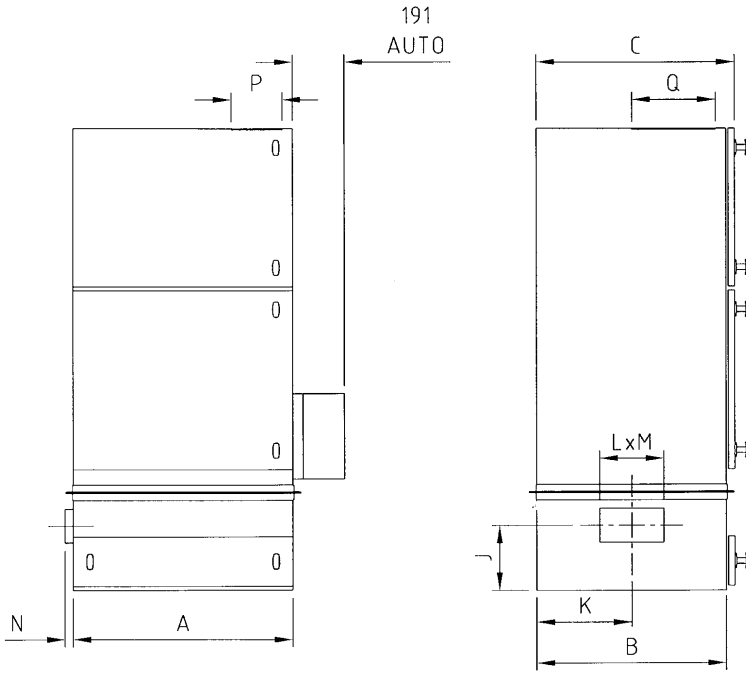

Type D Units

This designates drawer units and again describes the type of dust collector provided at the base. Assemblies are as above for hopper units, and they again range from 30 to 375 sq.ft. (2.7 - 34.84 m²).

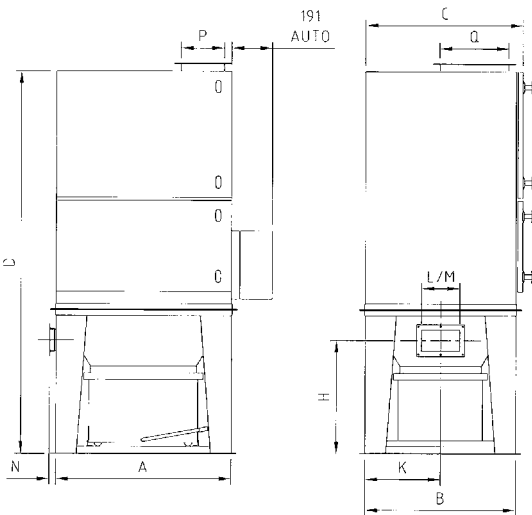

Type H Units

This designates hopper units and describes the type of dust collection provided at the base. They incorporate standard fan, filter and dust collecting assemblies with bolt on inlet to fit either side. They range from 30 to 825 sq.ft. (2.7 - 76.6 m²).

Specification													
Model	A mm	B mm	C mm	D mm	E mm	H mm	J mm	K mm	L mm	M mm	N mm	P mm	Q mm
FX 75	850	729	762	1885	1539	559	254	364	181	105	32	197	322
FX 100	850	729	762	2139	1793	559	254	364	244	130	32	197	322
FX 125	850	729	762	2139	1793	559	254	364	244	130	32	197	322
FX 150	850	729	762	2139	1793	559	254	364	244	130	32	197	322
FX 175	1161	881	914	2256	1909	711	406	440	283	156	32	472	272
FX 205	1161	881	914	2256	1909	711	406	440	283	156	32	472	272
FX 250	1161	881	914	2459	2112	711	406	440	345	181	32	472	272
FX 294	1161	881	914	2459	2112	711	406	440	345	181	32	472	272
FX 375	1161	998	1029	2670	2400	711	508	497	454	206	38	472	322
FX 440	1161	998	1029	2670	2400	711	508	497	454	206	38	472	322
FX 500	1610	998	1029	3160	-	864	-	497	549	232	38	522	472
FX 600	1610	998	1029	3160	-	864	-	497	549	232	38	522	472
FX 750	2055	1125	1156	3210	-	915	-	562	613	308	50	747	472
FX 825	2055	1125	1156	3210	-	915	-	562	613	308	50	747	472

Explosion Doors

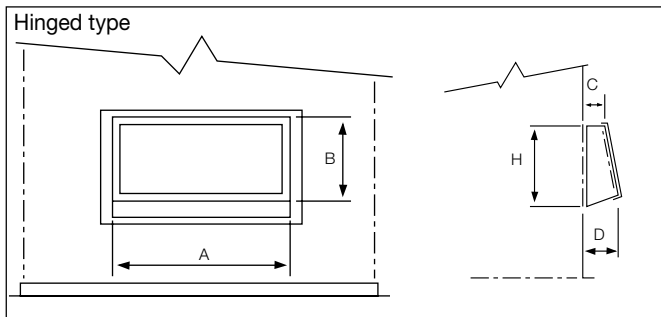

Explosion relief doors are fitted as standard to the rear of the unit

Specification					
Model	A mm	B mm	C mm	D mm	H mm
FEX 30	300	150	40	75	200
FEX 50	400	150	40	75	200
FEX 75	400	190	50	90	220
FEX 100 & 150	460	230	50	90	265
FEX 175 & 205	600	280	60	115	320
FEX 250 & 294	760	285	60	115	325
FEX 375 & 440	760	460	75	150	515
FEX 500 & 600	915	460	75	150	515
FEX 750 & 825	2 off FEX 375 fitted equi-spaced on rear				

Due to the continued improvement of our products, specifications may vary from those provided in this leaflet. We reserve the right to alter specifications and dimensions without prior notice. Any non standard sizes manufactured to specific requirements. All dimensions quoted are approximate.



Fine Dust Filter Units

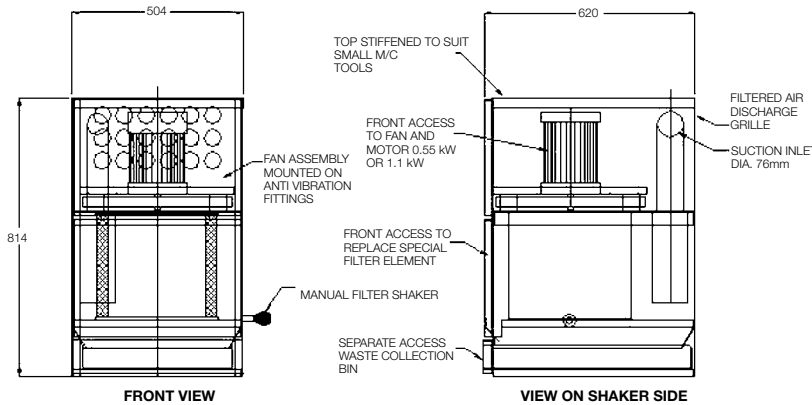

Specification					
Model	Standard Fan Rating	Filter Area	Motor Power	Collection Capacity	Noise Level
CF3	510 m ³ /hr @ 70mm	3 m ²	1.1 kW 220/415/50 2 Pole	0.015 m ³	82 dB(A)@2mtrs
CF5	510 m ³ /hr @ 70mm	3 m ²	1.1 kW 220/415/50 2 Pole	0.015 m ³	82 dB(A)@2mtrs

SIZE MATTERS –

Large filter area – minimum footprint

The CF3 and CF5 dust extraction units have been specifically designed for fine dusts and light loads created by various processes.

The CF range utilises a powerful free-vortex fan (secured on AV mounts for smooth running), which collects dust at source, drawing it through ducting and depositing it in the filter system, with the cleaned extracted air discharged to the atmosphere.

One of the unique advantages the CF range has over similar sized equipment is their exceptionally large filter area. This large filter area allows operation at much lower filter speeds, enabling maximum filtration efficiency.

The CF3 filter is cleaned using the manual shaker mechanism at the end of each working period, when residue can be removed via the quick-release metal drawer. The CF5 filter is replaced when saturated.

As well as the versatility of their size, the CF range have numerous filter options, enabling use with all kinds of different dry dusts and fumes.

The CF3 features a dry cartridge filter, whilst the CF5 has a microglass and optional carbon filter, which is ideal for light dust and fumes. Oleophobic/hydrophobic filters can also be fitted to handle light oil, water mists and dusts. A complete range of filter types and sizes are offered with different spacings, coatings and shapes to provide solutions for virtually any problem.

Water Scrubber Dust Extractors



Specification				
Model	Height mm	Width mm	Depth mm	Spigot Dia. mm
FF30	724	795	630	76
FF50	780	795	630	125

Technical Data					
Model	Water Capacity Litres	Fan Motor kW	Motor Enclosure	Noise Level dB(A) @ 2mtrs	Capacity
FF30	60	0.75	TEFVIP 54 (min)	82	0.93m ³ at 900pa to 0.14m ³ /s at 675pa 200CFM at 3.5"wg to 300CFM at 2.75"wg
FF50	79	1.10	TEFVIP 54 (min)	78	0.19m ³ /s at 900pa to 0.25m ³ /s at 675pa 400CFM at 3.5"wg to 520CFM at 2.75"wg

Ideal for Aluminium and other flammable dusts

Wet Dust Extractors

The FF30 unit and the larger capacity FF50 unit are continuously-rated dust collectors using a self-induced water spray to wash dust particles out of the entrapped air. Particles sink to the base of the integral collection tank, where they may be easily removed by raking into a container.

The water level in the unit (from a simple connection to the mains supply) is automatically controlled.

Wet dust collection is mandatory where explosive dusts from materials like aluminium, titanium and magnesium are involved plus special controls. Normally available in mild steel with hammer enamel finish. The units may also be specified in stainless steel when operating in more corrosive conditions.

Technical Information

Body: Constructed from 2mm sheet steel. Inside finished in water-resistant epoxy paint.

Fan: Free vortex, directly driven at 2880 rpm. Fan and motor assembly are supported on anti-vibration mounts, which together with electronic balancing results in a very smooth-running fan.

Water controls: evaporated water is automatically replenished via a simple ball float and solenoid valve (with additional fitting for special applications).

Sludge removal is carried out manually by raking the slurry into a bin for easy removal.

Due to the continued improvement of our products, specifications may vary from those provided in this leaflet. We reserve the right to alter specifications and dimensions without prior notice. Any non standard sizes manufactured to specific requirements. All dimensions quoted are approximate.

